

Hyclean™ Seal

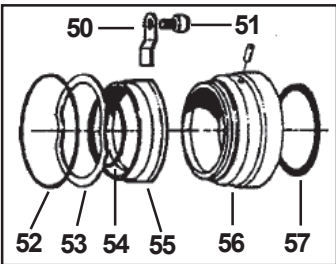

Flushed Hyclean Seal

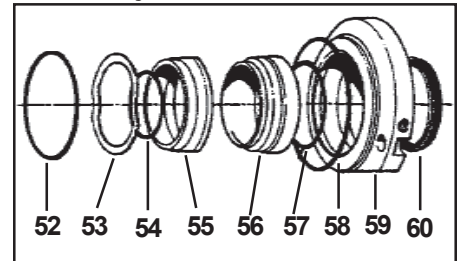

Positive Displacement Pump 722/732 GHPD (Horizontal)

Pos.	Qty.	Description	722/732 Part No.
1	1	Gear case	5220-081
2	2	Dowel	5170-010
3	4	Stud, RC-gear case	6350-138
4	4	Nut, RC-gear case	5330-001
4a	4	Washer	6400-038
5	1	Gear case cover	5120-048
6	6	Screw	5990-030
7	1	Lip seal, Nitrile	5310-012
	1	Lip seal, FPM	5310-082
8	1	Shim set, SS	6150-157
	1	Shim set, Plastic	6150-158
8a	2	Shim retainer	6150-275
8b	4	Screws.	6000-010
9	1	Rotor case, 722	9217-1491
	1	Rotor case, 732	9218-1501
10	8	Stud front cover	6350-095
11	1	Front cover O-ring, Nitrile	883-1550-273
	1	Front cover O-ring, FPM	883-1551-273
	1	Front cover O-ring, PTFE	1552-273
	1	Front cover O-ring, EPDM	883-1555-273
12	1	Front cover	31497-5130-315
13	8	Front cover nut	5340-047
14	2	Retainer (front bearing)	5560-036
15a	4	Retainer screw	5990-030
15b	2	Screw (Long)	5990-017
16	2	Lip seal, Nitrile	5310-043
	2	Lip seal, FPM	5310-076
18	2	Rotor O-ring, Nitrile	883-1550-135
	2	Rotor O-ring, FPM	883-1551-135
	2	Rotor O-ring, PTFE	1552-135
	2	Rotor O-ring, EPDM	883-1555-135
20	2	Rotor nut O-ring, Nitrile	883-1550-133
	2	Rotor nut O-ring, FPM	883-1551-133
	2	Rotor nut O-ring, PTFE	1552-133
	2	Rotor nut O-ring, EPDM	883-1555-133
21	1	Rotor nut, 722 R.H.	31497-5900-169
22	1	Rotor nut, 722 L.H.	31497-5900-189
21	1	Rotor nut, 732 R.H.	31497-5900-170
22	1	Rotor nut, 732 L.H.	31497-5900-190
23	1	Drive key	5270-013
24	1	Drive shaft, SS	31497-6110-659
	1	Drive shaft, Duplex	31497-6110-663
25	1	Lay shaft, SS	31497-6100-667
	1	Lay shaft, Duplex	31497-6100-671
26	4	Rear bearing	5080-015
27	1	Shaft spacer	31497-5670-067
28	2	Rear bearing spacer	5670-049
29	2	Front bearing spacer	5670-051
30	2	Rear nut	5340-035
31	4	Front bearing	5080-017
34	2	Front nut	5340-045
35	1	Gearcase lipseal nitrile	5310-045
36	2	Timing gear, hard	5210-034
37	2	Torque locking assembly	5615-005
45	1	Drain plug	1660-008
46	2	Sight level glass	5480-001
47	2	Filler plug	31491-0052-1
	2	Filler plug washer	31499-5916-1

Recommended Spare Parts: Pos. 7, 11, 16, 18, 20, 26, 31 and shaft seals

Pos.	Qty.	Description	722 Part No.	732 Part No.
Trilobe Rotors (SS)				
17	2	Class "A"	31497-5740-1161	31497-5740-1681
	2	Class "B"	31497-5740-1162	31497-5740-1682
	2	Class "C"	96300-4805-7	96300-4806-0
	2	High pressure class "A"	31497-5740-1164	31497-5740-1684
	2	High pressure class "B"	31497-5740-1165	31497-5740-1685
	2	High pressure class "C"	96300-4805-9	96300-4806-2

Bilobe rotors (SS) (Bilobe rotors must be ordered in pairs)

17	1	Class "A"	96300-9061-5	96300-9062-1
	1	Class "B"	96300-9061-6	96300-9062-2
	1	Class "C"	96300-9061-7	96300-9062-3
	1	High pressure class "A"	96300-9061-8	96300-9062-4
	1	High pressure class "B"	96300-9061-9	96300-9062-5
	1	High pressure class "C"	96300-9062-0	96300-9062-6

Pos.	Qty.	Description	722/732 Part No.
------	------	-------------	---------------------

Hyclean™ Seal

50	1	Clip	31495-5087-053
51	1	Screw	5990-064
52Δ	1	Rotor case O-ring, EPDM	883-1555-335
	1	Rotor case O-ring, Nitrile	31497-5001-1
	1	Rotor case O-ring, FPM	883-1551-335
53Δ	1	Wave spring	31497-0508-1
54Δ	1	Shaft O-ring, EPDM	88315-5533-5
	1	Shaft O-ring, Nitrile	883-1550-137
	1	Shaft O-ring, FPM	883-1551-137
55Δ	1	Stationary face, Carbon	31497-0501-2
	1	Stationary face, Silicon Carbide	31497-0501-3
56Δ	1	Rotary face, SS	31497-0506-1
	1	Rotary face, Silicon Carbide	31497-0506-3
57Δ	1	Washer, Nitrile	6400-072
	1	Washer, FPM	6400-076
58	1	Flush housing O-ring, EPDM	5380-409
	1	Flush housing O-ring, Nitrile	5380-406
	1	Flush housing O-ring, FPM	5380-407
59	1	Flush housing	3149-75265-391
60	1	Lip seal, Nitrile	5310-021
	1	Lip seal, FPM	5310-052
not listed	2	Housing screw	5990034
	2	Plug	5470004

Hyclean Seal Kit

Δ	C/SS, Nitrile	31497-7600-1051
Δ	C/SS, FPM	31497-7600-1052
Δ	C/SS, EPDM	31497-7600-1055
Δ	C/SC, Nitrile	31497-7600-1851
Δ	C/SC, FPM	31497-7600-1852
Δ	C/SC, EPDM	31497-7600-1855
Δ	SC/SC, Nitrile	31497-7600-2051
Δ	SC/SC, FPM	31497-7600-2052
Δ	SC/SC - EPDM	31497-7600-2055

Parts marked with Δ are included in the Hyclean seal kit.

Note! Two seal kits are required per pump.

Recommended Spare Parts: Pos. 7, 11, 16, 18, 20, 26, 31 and shaft seals

Alfa Laval
8201 104th Street
Pleasant Prairie, WI 53158-0909
Telephone: 800-558-2060
Fax: 262-947-4724
www.alfalaval.com